

Slurry Channel

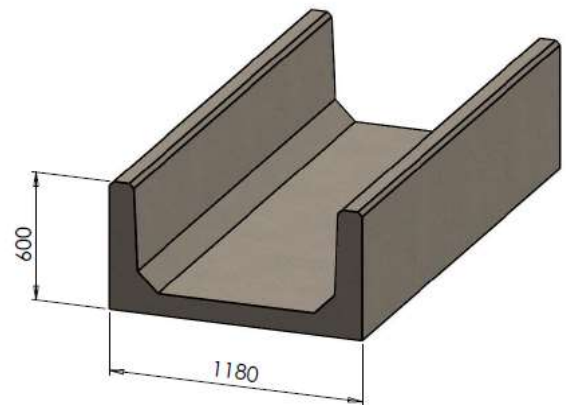
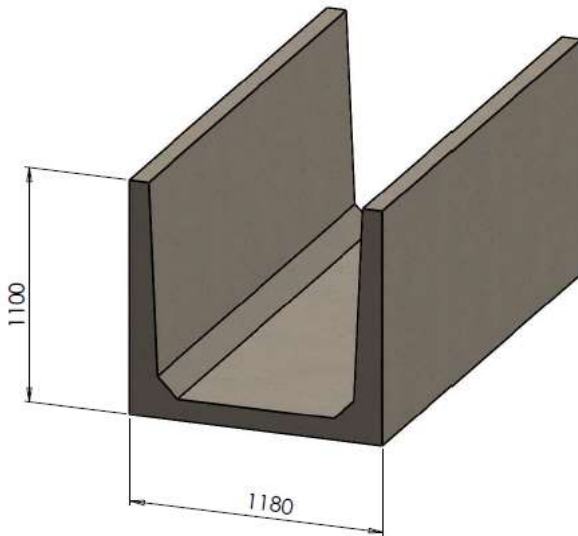

Description

- 1180mm x 2438mm
- 4ft x 8ft approximately
- Weight 2000kg approximately

Each unit also has M16 threaded lifting eyes cast in for the use of lifting loops for positioning. These can also be used to fit shuttering to form weirs along the base of the channel to promote the flow of slurry.

West Country Concrete Products Ltd

Endford works, Shebbear, Devon, EX21 5RY

Tel: 01409 281 437 Fax: 01409 281 732 email: info@westcountryconcreteproducts